



Water Treatment



CONNECTORS AND ACCESSORIES

For water treatment and beverages dispenser





Our ideas our strength.

A fast information,
order management and
flexibility of production,
are the basis of our
service.



SUMMARY

Manifold	8
Push-in connector c/w cartridge	12
Bayonet head push-in connectors	18
Special connectors	34



PUSH-IN CONNECTORS, MANIFOLD AND SPECIAL CONNECTORS are used for water, beer and wine installation.

In the water treatment market, our products are used in both reverse osmosis machines and water coolers.

For over 20 years, Pres Block has been committed to satisfying its customers' requirements.

It is, in fact, thanks to listening carefully to customer requests that the bayonet and cartridge systems came into being.

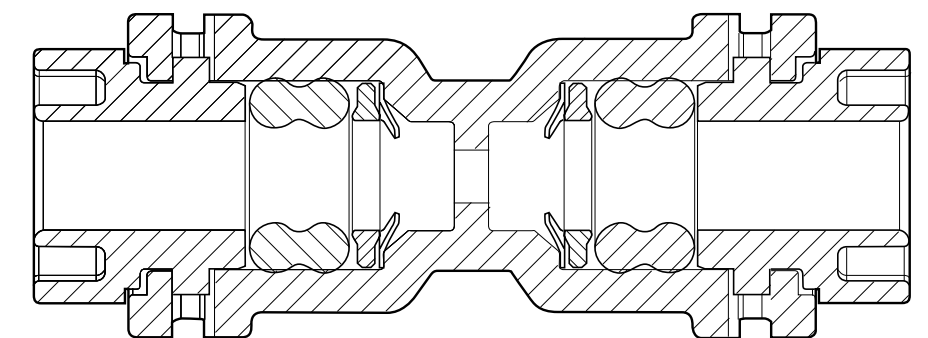
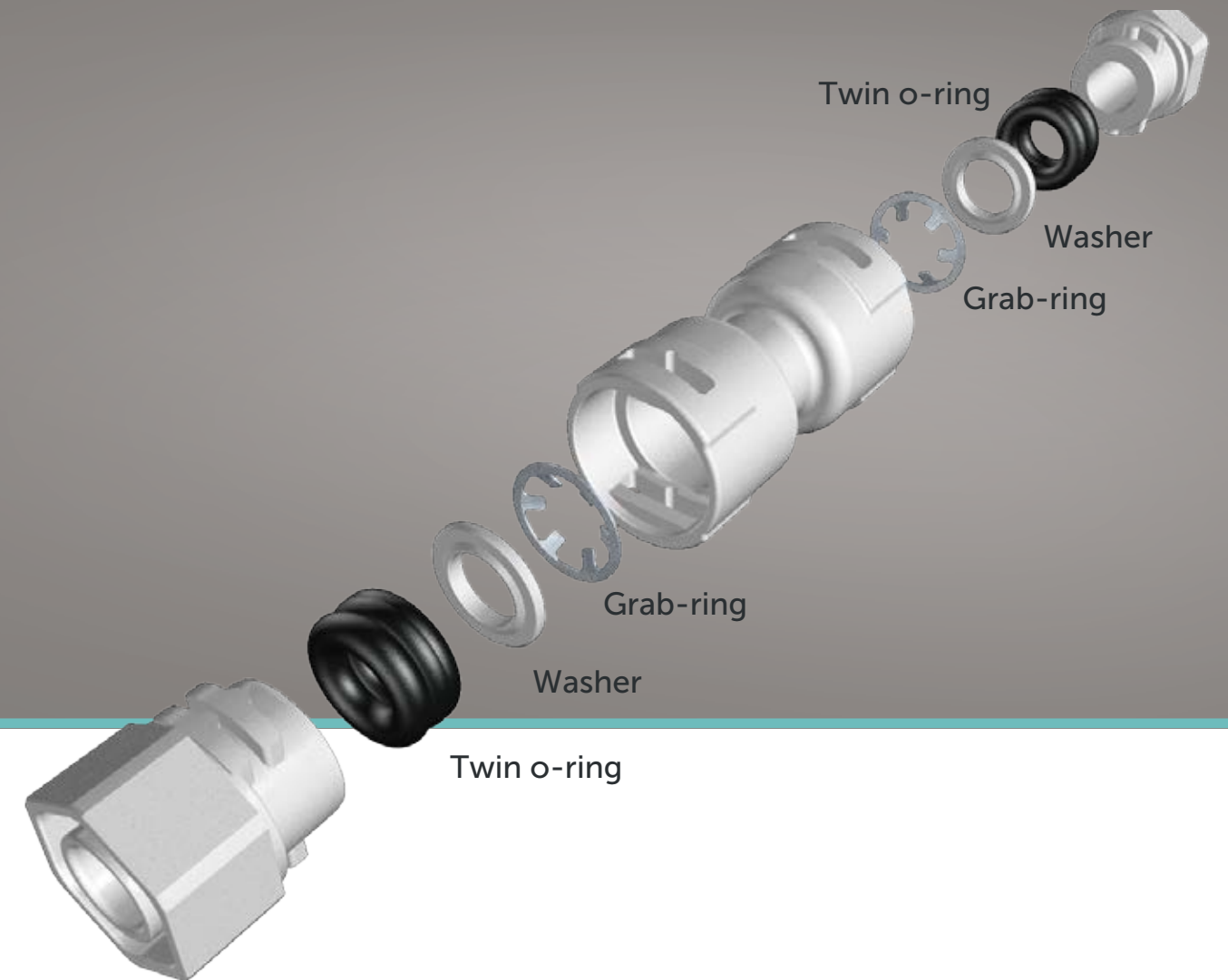

External shape

PA 6,6 FV30%
PA 6,6 - POM
Polycarbonate

Internal components

O-ring: EPDM Perox 70sh
Grab-ring: Stainless steel 12 RP

Working pressure range

0 bar < P < 10 bar

Working temperature range

-20 °C +120 °C



MANIFOLDS

Our primary objective is customer satisfaction; for this reason we have come up with the most functional and practical solutions in the manifold field, for an intelligent and profitable use.

Our 4 and 5-way manifolds are designed to integrate all the necessary functions for both domestic use and non, into a single push-in connector, in order to reduce the numerous combinations present in the fluid circuit.

They are provided with one-way check valves (non-return valves) which guarantee the flow of water in one direction only, swivel outlets and quick connectors which enable them to be used in a safe and simple way.

Our products can make the fluid circuit easier during the installation phase.



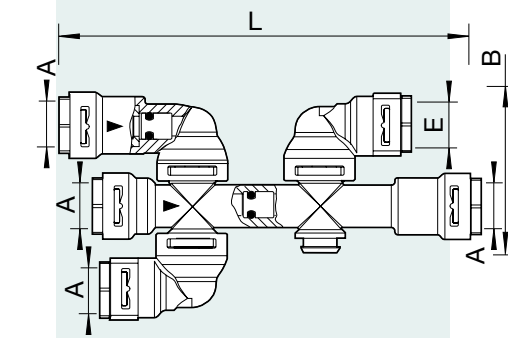

5 way swivel outlet manifold c/w two check valves and push-in connectors				
P/N	A	B	E	L
RDISRG1/4-5/1VA	1/4"	49	6	118

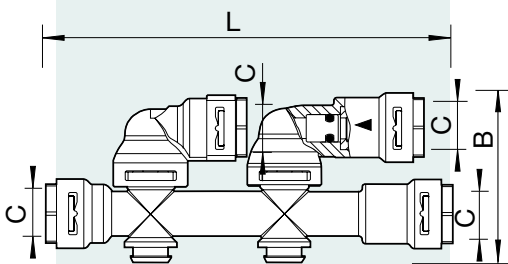

4 way swivel outlet manifold c/w check valve and push- in connectors			
P/N	B	C	L
RDISRG8-4	49	8	118
RDISRG1/4-4/61V	49	1/4"	118
RDISRG6-4	49	6	118

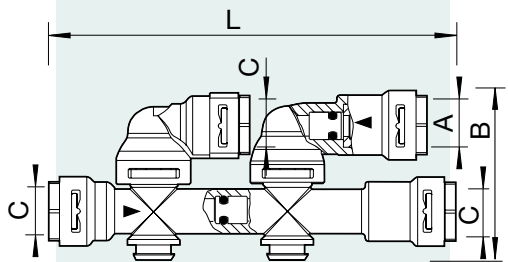

4 way swivel outlet manifold c/w two check valves and push-in connectors				
P/N	A	B	C	L
RDISRG1/4-4/1VB	4	49	1/4"	118

5 way swivel outlet manifold c/w two check valves and push-in connectors						
P/N	A	B	C	E	L	F
RDISRG1/4-5/61V	6	48,9	1/4"	1/4"	118	1/4"
RDISRG1/4-5/1VB	6	48,9	1/4"	4"	118	1/4"

4 way swivel outlet manifold c/w three check valves and push-in connectors			
P/N	B	C	L
RDISRG6-4-VNR	49	6	118
RDISRG8-4-VNR	49	8	118

5 way swivel outlet manifold c/w three check valves and push-in connectors			
P/N	A	E	L
RDISRG6-5-VNR	6	69	118
RDISRG8-5-VNR	8	69	118

5 way swivel outlet manifold c/w three check valves and push-in connectors				
P/N	A	B	E	L
RDISRG1/4-5/62V	1/4"	69	6	118

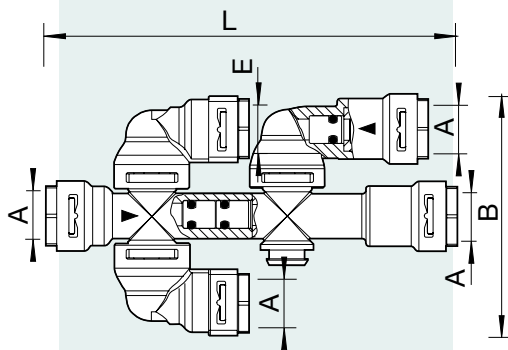
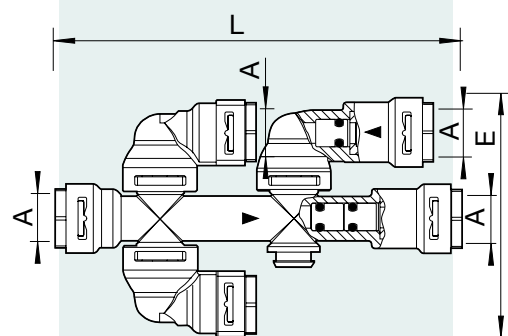
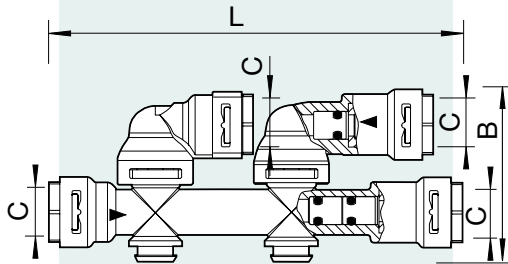
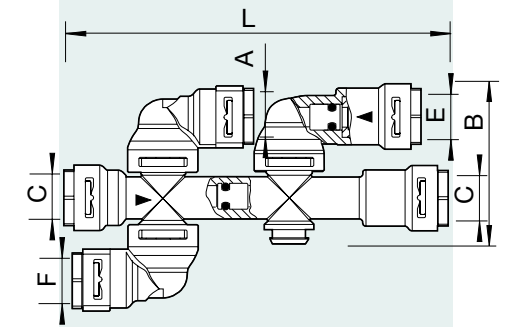

Consult our technical-sales department for all your needs.

Consult our technical-sales department for all your needs.



PUSH-IN CONNECTOR C/W CARTRIDGE

In this catalogue we have included quick connectors using a cartridge system in the following versions:

straight, elbow, and "T", as well as flow regulators.

Thanks to the use of these removable cartridges, it is possible to create a special, personalized connector which is able to reduce the junction points within the fluid circuit, thus saving on costs.



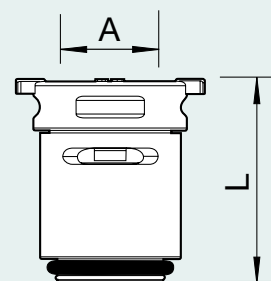

Cartridge c/w push-in connector			
P/N	A	L	
RRC06	6	25	
RRC1/4	1/4"	25	
RRC08	8	25	
RRC3/8	3/8"	25	

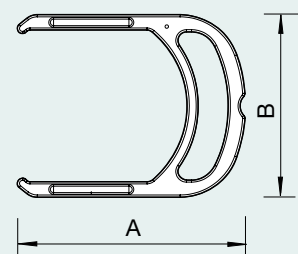

Locking clip for cartridge			
P/N	A	B	
RRDF-CLIP	27	21	

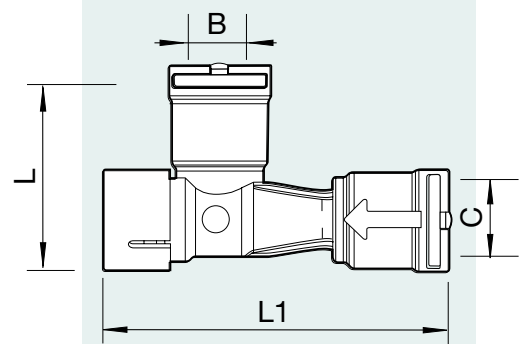

Flow regulator for beverage dispenser					
P/N	B	C	L	L1	
RRBG06-RDF	6	6	48,7	81,5	
RRBG1/4-RDF	1/4"	1/4"	48,7	81,5	
RRBG08-RDF	8	8	48,7	81,5	
RRBG3/8-RDF	3/8"	3/8"	48,7	81,5	

Consult our technical-sales department for all your needs.

Straight push-in connector			
P/N	L	L1	
RRCD-1	53	23,5	
Cartridge not included			

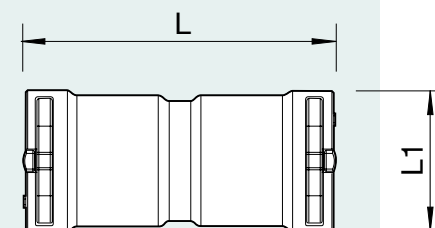

Elbow push-in connector			
P/N	L	L1	
RRCG-1	51	51	
Cartridge not included			

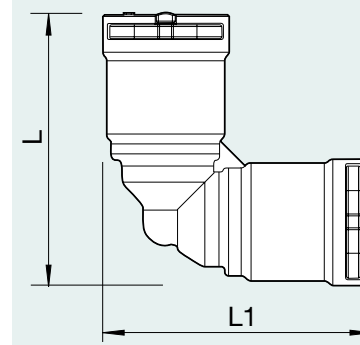

Tee push-in connector			
P/N	L	L1	
RRCT-1	68,5	46	
Cartridge not included			

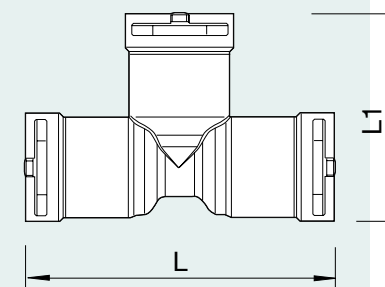

Consult our technical-sales department for all your needs.

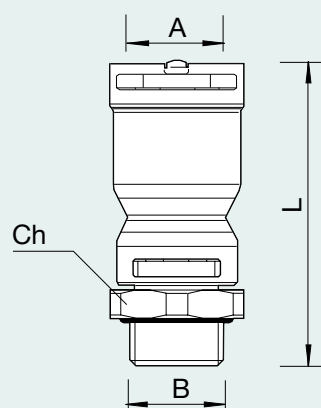
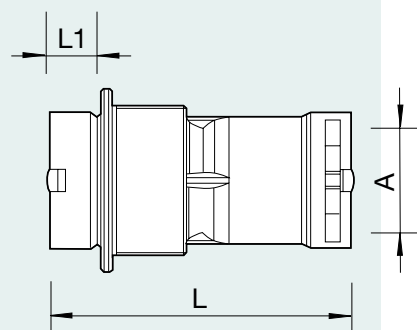
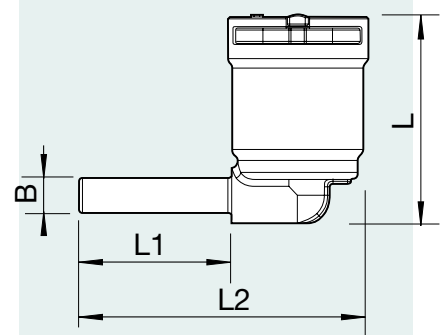

Elbow push-in connector with stem

P/N	B	L	L1	L2
QRCGC06	6	35,5	26	50
QRCGC08	8	35,5	26	50
QRCGC3/8	3/8"	35,5	26	50

Cartridge not included

Bulkhead straight push-in connector c/w locking nut

P/N	A	L	L1
RRCDPP-1	3/4"	54	11

Cartridge not included

Pump straight push-in connector c/w M3/8" thread

P/N	A	B	Ch	L
RRCDGIR06	3/8"	6	24	54
RRCDGIR06	3/8"	8	24	54
RRCDGIR06	3/8"	3/8"	24	54

C/w o-ring

Consult our technical-sales department for all your needs.





BAYONET HEAD PUSH-IN CONNECTORS

In order to offer its customers a useful and efficient alternative, Pres Block has designed these bayonet head push-in connectors, thus bringing together both moulding skills and the use of the O-ring with excellent results.

In the bayonet connectors there are a grab ring, a plastic washer and a double-O ring.

In particular, after having placed the grab ring at the end of the chamber, Pres Block inserts the plastic washer: this sequence is useful in avoiding an unauthorised use by third parties.

The important last step is the installation of the double O-ring, made from a special mould, which takes on the "shape of infinity". This guarantees a better sealing, even with heavy lateral loads.



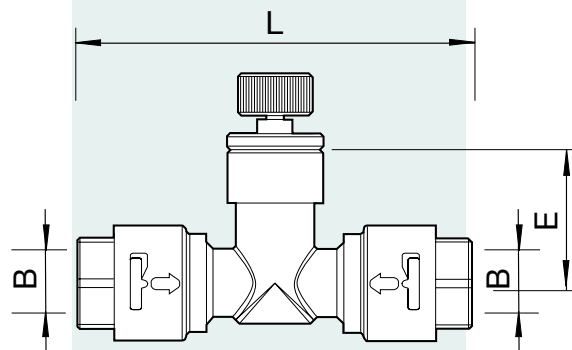

Flow regulator with push-in connectors for osmosis

P/N	B	E	L
PRDFDRR06	6	27	57,6
PRDFDRR06	1/4	27	57,6

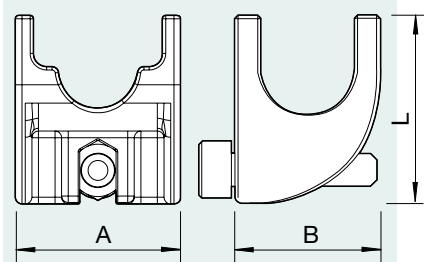

Bracket for flow-regulator for osmosis

P/N	A	B	L
RRDFDRR06M5	25	21	28,5

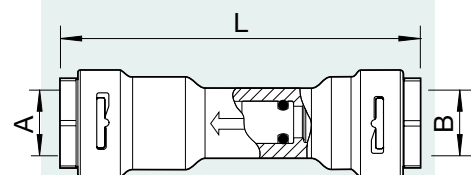

Check valve with push-in connectors

P/N	A	B	L
RRBD0406/61V	4	6	60
RRBD041/4/61V	4	1/4"	60
RRBD06/61V	6	6	60
RRBD1/4/61V	1/4"	1/4"	60
RRBD08N-VNR	8	8	60
RRBD3/8E1VNR	3/8"	3/8"	60
RRBD10E1VNR	10	10	60

Consult our technical-sales department for all your needs.

Double check valve with push-in connectors complying with IEC 61770:98 + A1:04 + A2:06 standard

P/N	A	B	L
RRBD06/62V	6	6	67
RRBD1/462V	1/4"	1/4"	67
RRBD08/62V	8	8	67
RRBD3/8/62V	3/8"	3/8"	67
RRBD10/62V	10	10	67

Check valve c/w filter and push-in connectors

P/N	A	B	L
RRBD08N-VNRF	8	8	73

Filter with push-in connectors

P/N	A	B	L
RRBD10E-FIL	10	10	67,5
100 Micron mesh			

Consult our technical-sales department for all your needs.

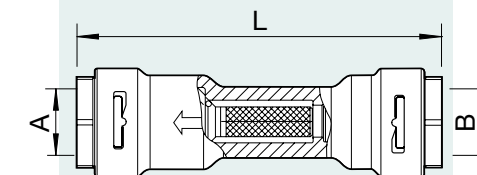
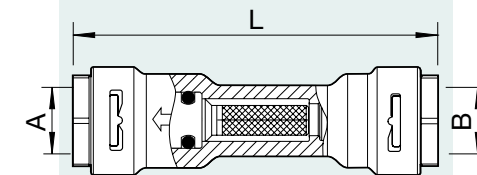
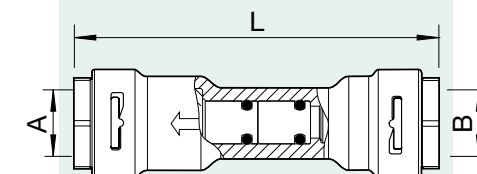

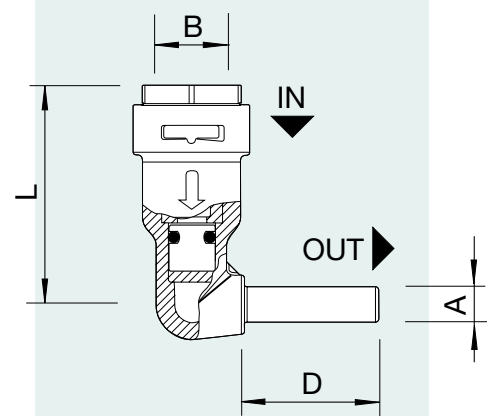

Elbow push-in connector-stem c/w check valve				
P/N	A	B	D	L
RRBG6C06VNR	6	6	23	27
QRBG1/4C1/4VNR	1/4"	1/4"	23	27

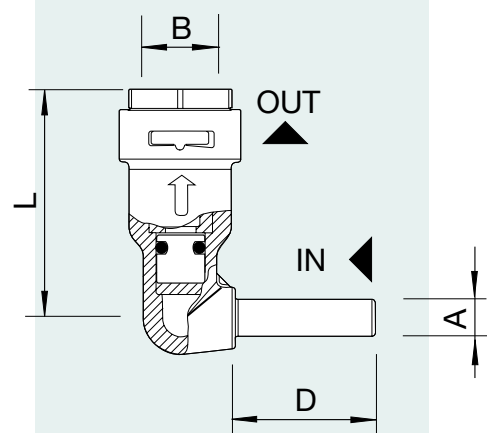

Elbow push-in connector-stem c/w check valve				
P/N	A	B	D	L
RRBG6C06VNR/001	6	6	23	27
QRBG1/4C1/4VNRB	1/4"	1/4"	23	27

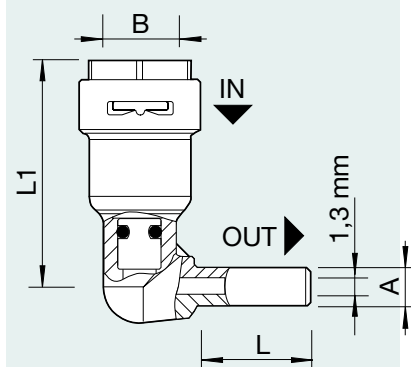

Elbow push-in connector c/w check valve and orifice of 1,3mm				
P/N	A	B	L	L1
QRBG1/4C1/4FCVN	1/4"	1/4"	24,5	27
QRBG1/4C3/8FCVN	3/8"	1/4"	24,5	27

Consult our technical-sales department for all your needs.

Elbow push-in connector with stem				
P/N	A	B	D	L
QRBG06C1/4	1/4"	6	24	27
QRBG08C1/4	1/4"	8	24	27
QRBG08C12	12	8	24	27
QRBG3/8C1/4WW	1/4"	3/8"	18	27
QRBG10C10	10	10	28	27
RRBG08C08	8	8	24	27
QRBG08C06	6	8	24	27
QRBG06C08	8	6	24	27
QRBG06C06	6	6	24	27
QRBG06C3/8	3/8"	6	34	27
QRBG08C3/8	3/8"	8	34	27

Elbow bulkhead push-in connector c/w check valve				
P/N	A	B	L	L1
QP24RB1/4C1/4VN	1/4"	1/4"	24	29
QP24RB06C06VN	6	6	24	29

Bulkhead push-in connector c/w check valve and calibrated hole				
P/N	A	B	L	L1
QP24RB1/4C1/4FC	1/4"	1/4"	24	29

Consult our technical-sales department for all your needs.

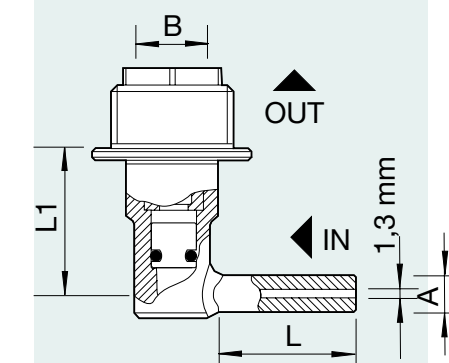
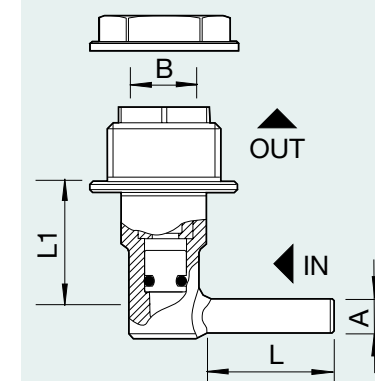
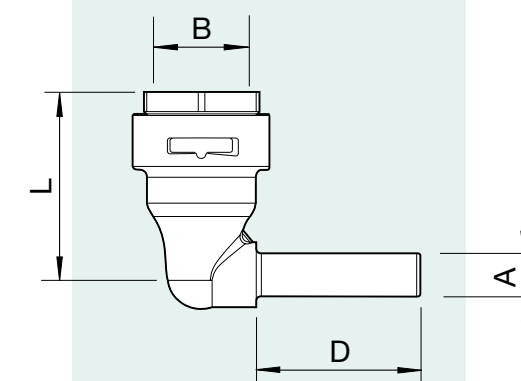

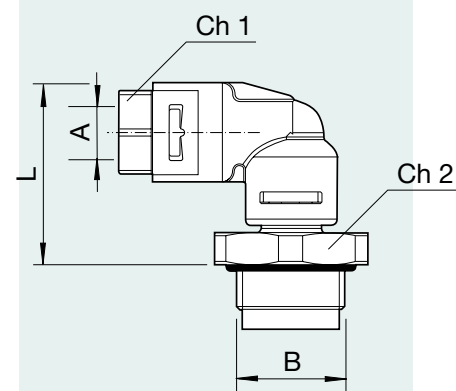

Elbow swivel push-in connector male threaded c/w o-ring					
P/N	A	B	Ch1	Ch2	L
RGPL13RR6/KS	6	3/8"	13	24	28
RGPL13RRB6	6	3/8"	17	24	33
RGPL13RRB8	8	3/8"	13	24	28,5
RGPL13RRB3/8	3/8"	3/8"	19	24	30
RGPL13RRB10	10	3/8"	19	24	30

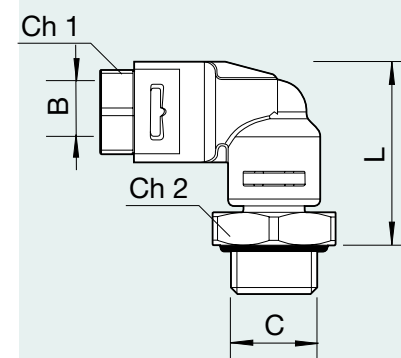

Elbow swivel push-in connector male threaded c/w o-ring					
P/N	B	C	Ch1	Ch2	L
RGPL12RRB4	4	1/4"	10	19	27
RGPL12RRB6	6	1/4"	17	24	27
RGPL12RRB8	8	1/4"	17	24	27
RGPL12RRB10	10	1/4"	19	24	27

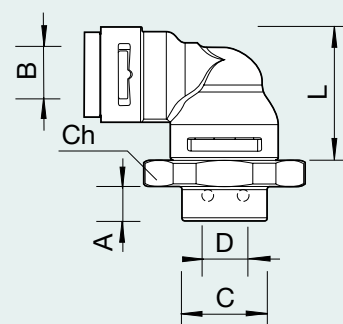

Elbow swivel push-in connector female threaded c/w o-ring						
P/N	A	B	C	Ch	D	L
RGPL22RRB4	7,5	4	1/4"	30	7	27
RGPL22RRB6	7,5	6	1/4"	24	7	33
RGPL22RR6	7,5	6	1/4"	30	7	28,5
RGPL22RRB1/4	7,5	1/4"	1/4"	30	7	33
RGPL22RR8	7,5	8	1/4"	30	7	33

Consult our technical-sales department for all your needs.

Elbow swivel push-in connector male threaded c/w two check valves				
P/N	A	B	L	L1
RGPL12RB06-2VNR	1/4"	6	52	28
RGPL13RB06-2VNR	3/8"	6	52	28

C/w o-ring

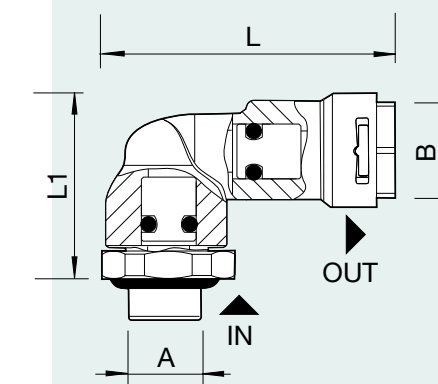

Elbow swivel push-in connector female threaded c/w two check valves				
P/N	A	B	C	L
RGPL22RB06-2VNR	7,5	1/4"	6	28

C/w o-ring

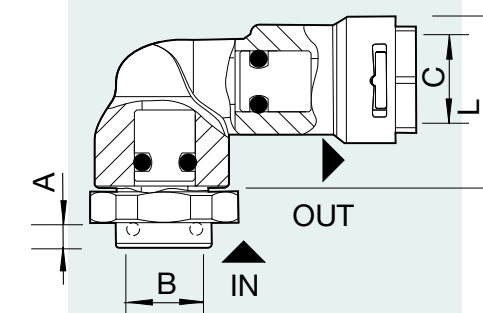

Elbow swivel push-in connector male threaded c/w check valve						
P/N	A	B	Ch1	Ch2	L	L1
RGVNR12RR4/KS	1/4"	4	19	10	37	26
RGVNR12RR6/KS	1/4"	6	19	17	39	28
RGPL12RB1/4VNR	1/4"	1/4"	24	17	41	33
RGVNR13RR6	3/8"	6	24	17	39	28
RGPL13RRB8VNR	3/8"	8	24	17	41	33

C/w o-ring

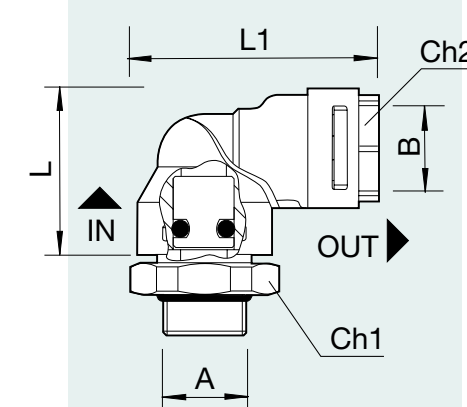

Consult our technical-sales department for all your needs.

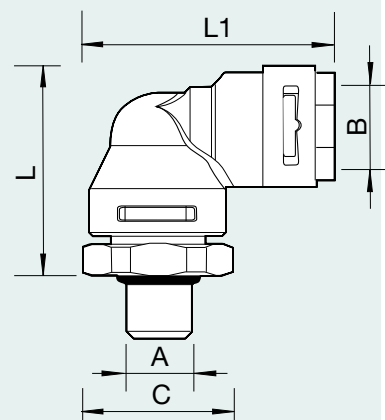

Elbow swivel push-in connector to M1/8" for drinking vessel						
P/N	A	B	C	L	L1	
RGPL01RRB6	1/8"	6	19	39	28	
RGPL01RB1/4	1/8"	1/4"	24	42	28	
RGPL01RRB8	1/8"	8	24	42	28	
RGPL01RRB3/8	1/8"	3/8"	24	42	28	
RGPL01RRB10	1/8"	10	24	42	28	

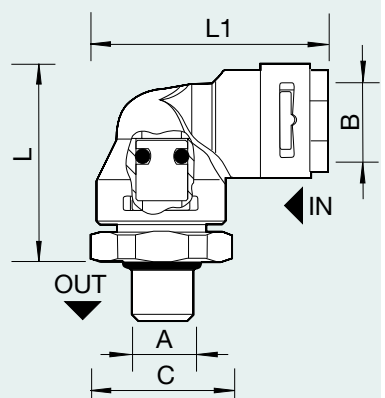

Elbow swivel push-in connector c/w check valve to M1/8" for drinking vessel						
P/N	A	B	C	L	L1	
RGPL01RRB6VNR	1/8"	6	24	42	28	
RGPL01RB1/4VNR	1/8"	1/4"	24	42	28	
RGPL01RRB8VNR	1/8"	8	24	42	28	
RGPL01RRB3/8VNR	1/8"	3/8"	24	42	28	

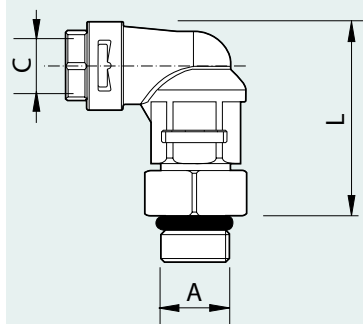

Elbow swivel push-in connector male threaded c/w o-ring				
P/N	A	C	L	
RRCBG11RR4/PO	1/8"	4	28	
RRCBG11RR6	1/8"	6	29	

Consult our technical-sales department for all your needs.

Elbow swivel push-in connector c/w o-ring for stainless steel coil						
P/N	A	B	Ch1	Ch2	D	L
RGPL13RR6-8/KS	3/8"	6	13	24	stainless steel coil	28

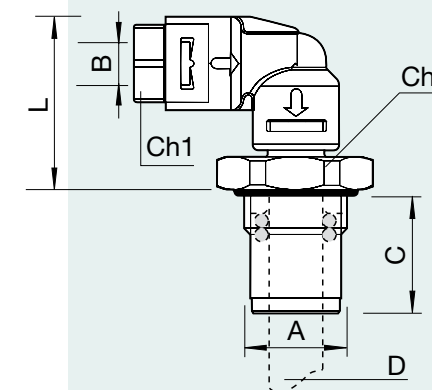

Tee push-in connector with swivel male threaded c/w o-ring						
P/N	A	B	C	L	L1	
RGPT12RRB1/4	1/4"	1/4"	6	58,5	26,5	
RGPT13RRB06	3/8"	6	6	58,5	26,5	

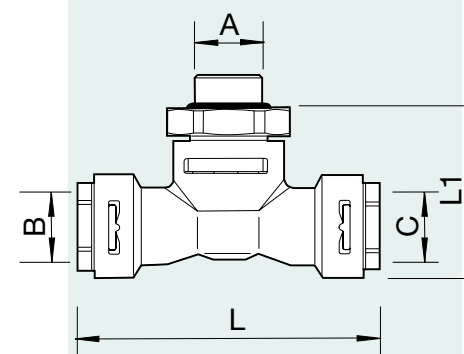

Bulkhead tee push-in connector c/w check valve and swivel male threaded						
P/N	A	B	C	L	L1	
RGPT11PP24RB1/4	1/4"	1/4"	1/8"	38	55	
RGPT12PP24RB1/4	1/4"	1/4"	1/4"	38	55	

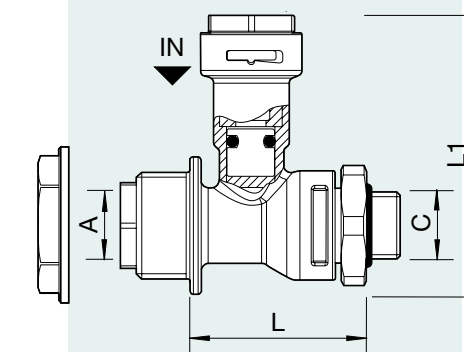

Consult our technical-sales department for all your needs.

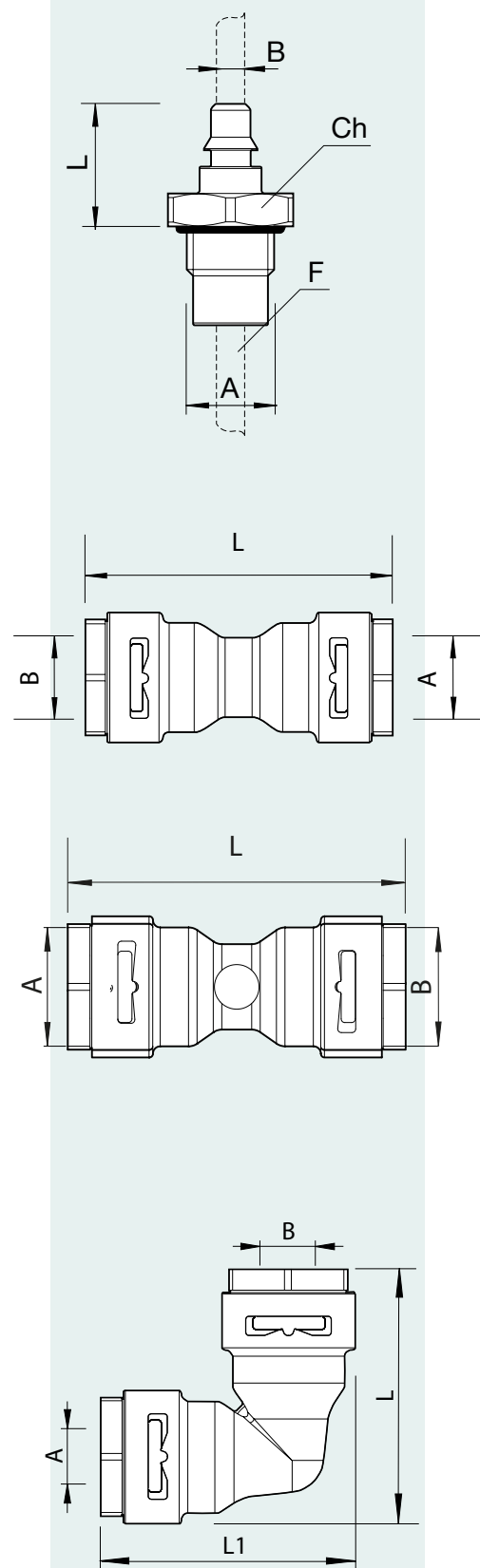

Probe case for carbonating device

P/N	A	B	Ch	L	F
RGPL12/KS	1/4"	7	19	18,5	Sonda ø4

Straight push-in connector

P/N	A	B	L
RRBD06	6	6	45
RRBD06-1/4	1/4"	1/4"	48
RRBD08N	8	8	48
RRBD10-8	10	8	50
RRBD10	10	10	50
RRBD12	12	12	50

Straight push-in connector c/w 0,8 mm orifice for osmosis

CODICE	A	B	L
RRBD08-06EE-FC	6	8	45

Elbow push-in connector

P/N	A	B	L	L1
RRBG06	6	6	34,5	34,5
RRBG8N1/4G1	1/4"	8	36	36
RRBG8N1/4G1	8	8	36	36
RRBG10-3/8	10	3/8"	42	42
RRBG1010	10	10	42	42
RRBG12/GT	12	12	42	42

Consult our technical-sales department for all your needs.

Elbow push-in connector c/w check valve

P/N	A	B	L	L1
RRBG8N1/4G1VNR	8	1/4"	42	47

Tee push-in connector

P/N	A	B	C	L	L1
RRBT04E	4	4	4	35	26,5
RRBT060406E	6	4	6	50	35
RRBT06E	6	6	6	50	35
RRBT1/4TN	1/4"	1/4"	1/4"	53,5	37
RRBT08N	8	8	8	53,5	37
RRBT10N	10	10	10	60	41
RRBT12/GT	12	12	12	60	44

Tee push-in connector c/w check valve

P/N	A	B	C	L	L1
RRBT6-6-6-VNR	6	6	6	69	37
RRBT8-1/4-4-VNR	4	1/4"	8	69	37
RRBT8-8-4-VNR	4	8	8	69	37

Consult our technical-sales department for all your needs.

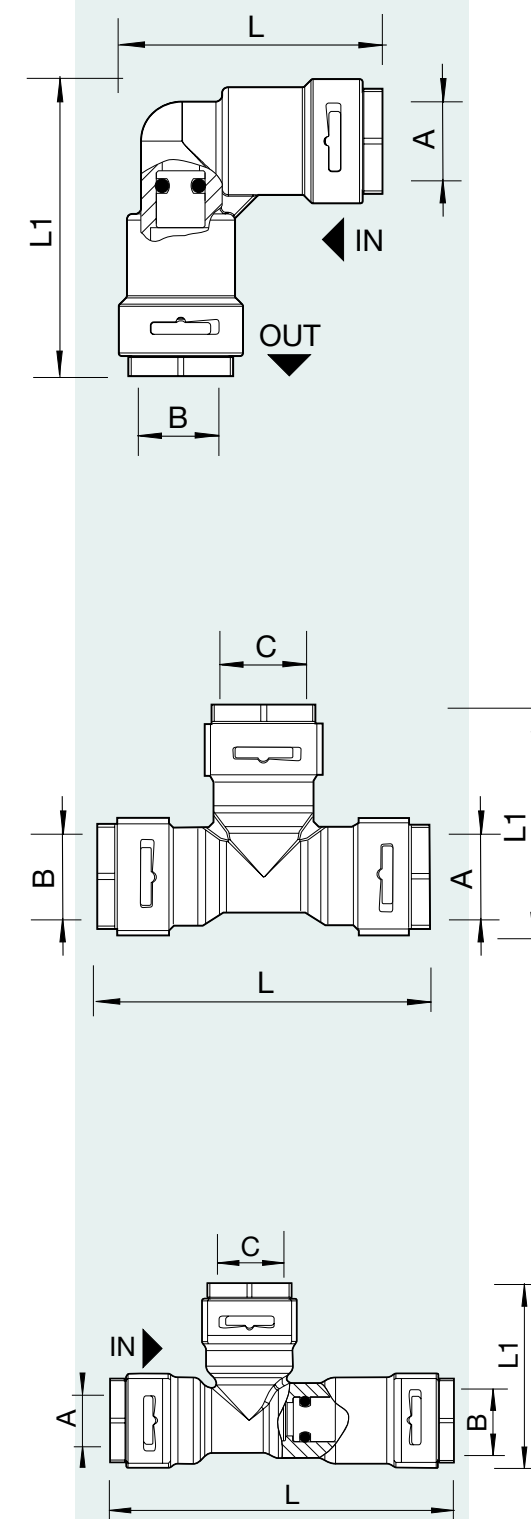

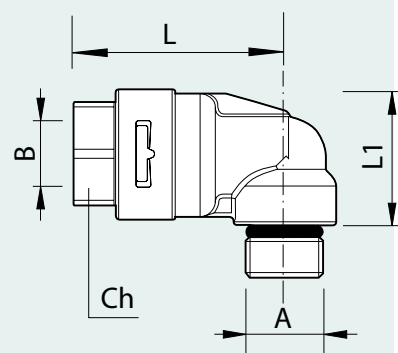

Elbow push-in connector male threaded c/w o-ring					
P/N	A	B	Ch	L	L1
RRBG06M1/8	1/8"	6	13	40	17
RRCB11RR4	1/8"	4	13	40	17

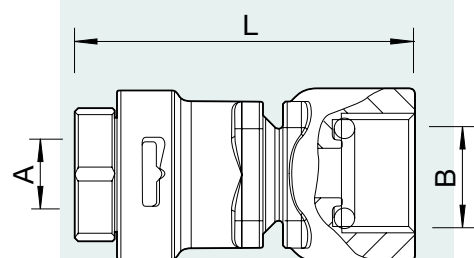

Straight push-in connector female threaded c/w o-ring			
P/N	A	B	L
RRBD04F1/8	4	1/8"	25,6

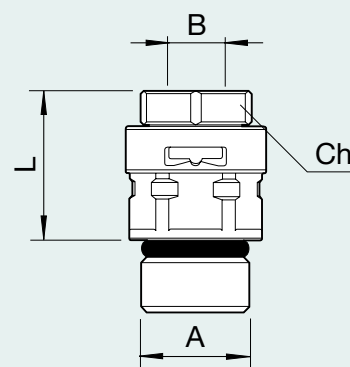

Straight push-in connector male threaded c/w o-ring				
P/N	A	B	Ch	L
RRBD04M1/8	1/8"	4	10	13,5
RRBD04M1/4	1/4"	4	19	28
RRBD06M1/4	1/4"	6	10	28
RRBD1/4M1/4	1/4"	1/4"	19	28
RRBD08M1/8TSMIN	1/8"	8	26	27
RRBD08M1/4/TF	1/4"	8	26	27
RRBD08M3/8/TF	3/8"	8	26	27

Consult our technical-sales department for all your needs.

Bulkhead cross swivel push-in connector c/w check valve and swivel male threaded						
P/N	A	B	C	D	L	L1
RGPG12PP24RB1/4	1/4"	1/4"	1/8"	1/4	82	28,5

C/w o-ring

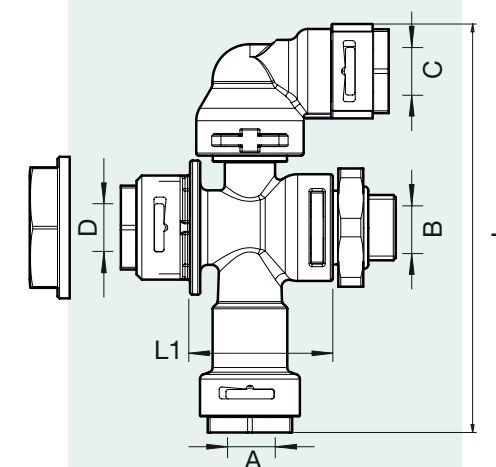

Elbow swivel push-in connector F3/4" threaded to anti-flooding valve				
P/N	A	B	L	L1
RRBG1/4F3/4	3/4"	1/4"	53	59
RRBG08N-F3/4	3/4"	8	53	42
RRBG3/8-F3/4	3/4"	3/8"	59	45

c/w gasket

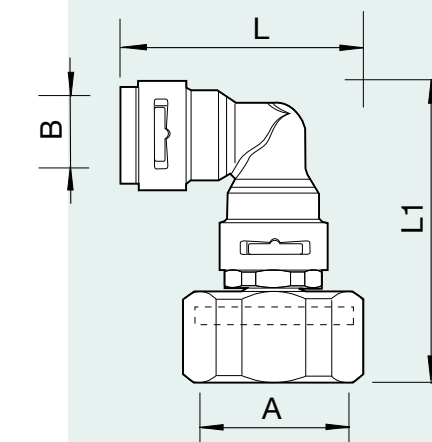

Bulkhead straight push-in connector c/w check valve & locking nut				
P/N	A	B	L	L1
RP14RBD6VNR	6	6	48	11,3
RP14RBD1/4VNR	1/4"	1/4"	48	11,3

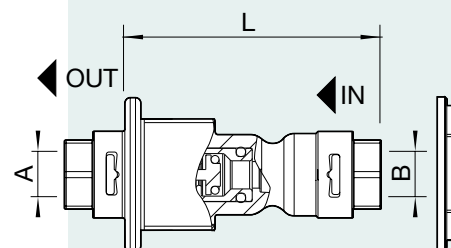

Consult our technical-sales department for all your needs.

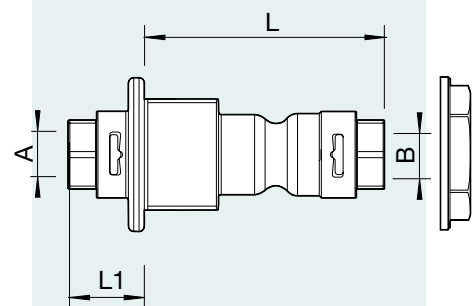

Bulkhead straight push-in connector c/w locking nut				
P/N	A	B	L	L
RP14RBD06	6	6	45	11,3
RP14RBD1/4	1/4"	1/4"	45	11,3

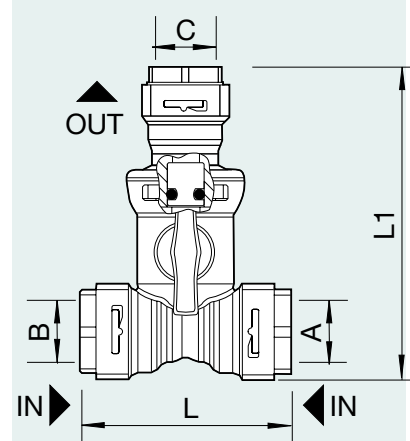

Tee ball valve push-in connector c/w check valve					
P/N	A	B	C	L	L1
QVSFRBT12G08VNR	12	12	8	55	81
QVSFRBT12D10VNR	12	12	10	55	81

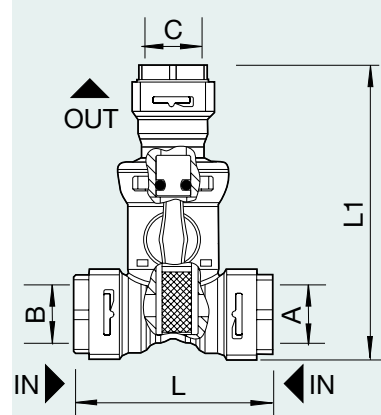

Tee ball valve push-in connector c/w check valve & filter					
P/N	A	B	C	L	L1
QVSFRBT12G08F	12	12	8	55	81

Consult our technical-sales department for all your needs.





SPECIAL CONNECTORS

Over the years, Pres Block has perfected its production, thus enabling us to use high-performance materials and resulting in a manufacturing process which has led to the substitution of metallic products with plastic ones.

Our strength is using raw materials and production processes as requested by our customers, together with the selection of materials which conform to the Alimentary Certifications, seeing as they come into contact with alimentary substances such as water, wine, beer and so on.

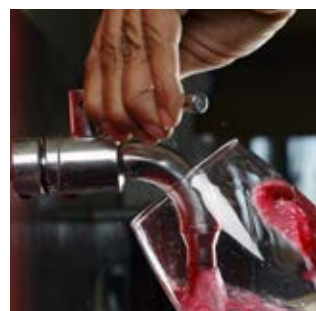



SPECIAL CONNECTORS

As we at Pres Block produce our own moulds, we are able to create innovative products and personalized configurations which meet customer requirements and which allow for a saving on costs when compared to the standard connectors.

Furthermore, with the development of a special connector, the junction points are consequently reduced.

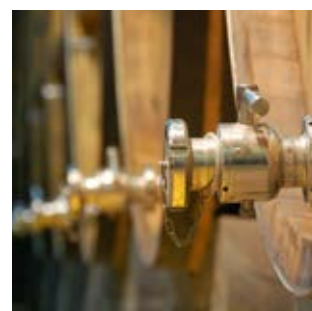

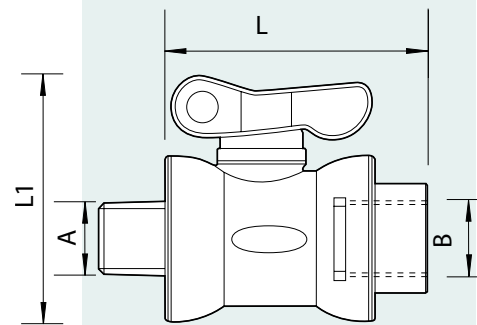

Ball valve M1/4" - F1/4"				
P/N	A	B	L	L1
QVSF022200	1/4"	1/4"	47,5	43
QVSF022201	1/4"	1/4"	39,5	43

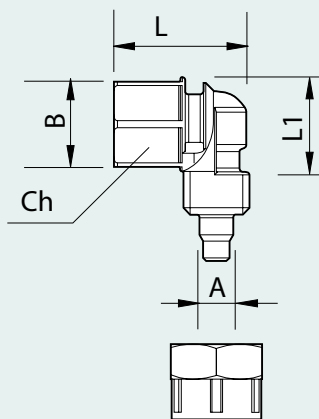

Elbow push-over connector female threaded					
P/N	A	B	Ch	L	L1
RRCB210006/PO	4x6	1/8"	13	20	14

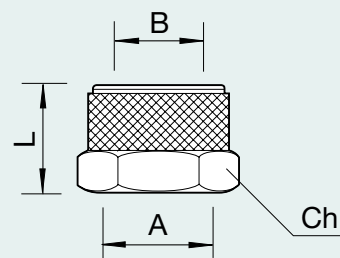

Push-over locking nut				
P/N	A	B	Ch	L
PDFE910Z06	M10x1	6,2	13	11,5
PDFE940Z10	M14x1	10,2	17	13

Push-over locking nut				
P/N	A	B	Ch	L
PDFE91SL06	M10x1	6,2	15	12,5
PDFE920008/RW	M12x1	8,5	15	12,5

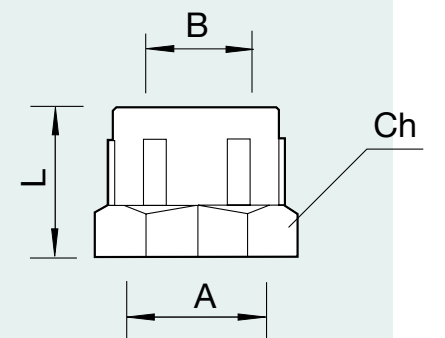

Ball valve M1/4" - F1/4"				
P/N	A	B	H	L
PVSF022200	1/4"	1/4"	44,5	29

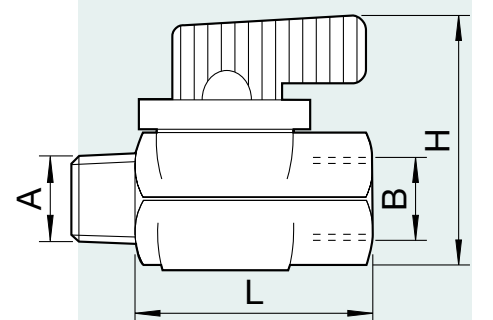

Bulkhead overflow connector						
P/N	A	B	C	D	L	L1
PTPI9400BE	14	35,2	29	M14X1	74	44,5

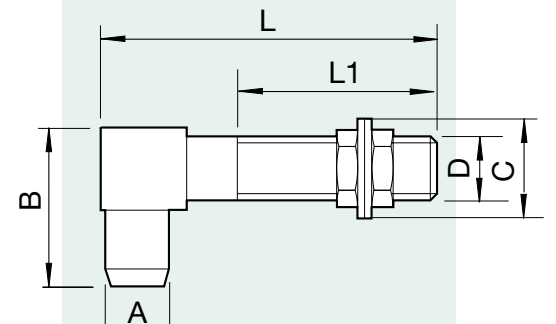

Consult our technical-sales department for all your needs.

Consult our technical-sales department for all your needs.

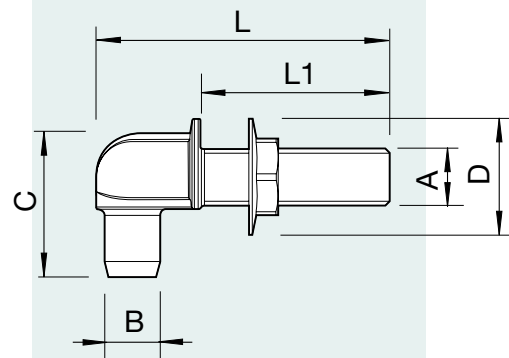

Integrated bulkhead overflow connector						
P/N	A	B	C	D	L	L1
PTPL9400BS	M14X1	14	40	29	73	47

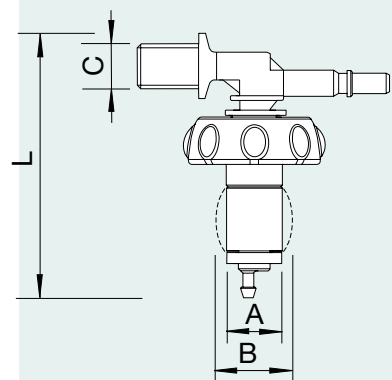

Wine dispenser				
P/N	A	B	C	L
RDISPI40M1/4/01	17	24	1/4	92

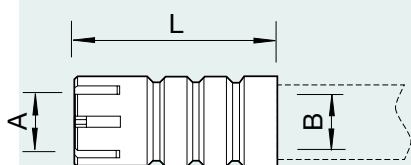

Filter				
P/N	A	B	L	Tubo
SFIL00TG00	4,5	5,6	18	Ø6

Tool for the maintenance of the bayonet head push-in connectors					
P/N	A	B	C	D	E
RRB-CH	6	8	10	12	14

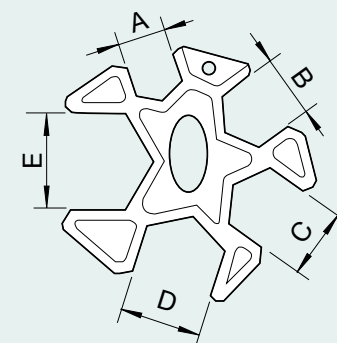

Plastic shaft for beer towers				
P/N	A	A1	B	B1
R170M1	1"	-	170	-
R170M1-1/2	1"1/2	-	170	-
PDFG00RD00	-	1"1/2	-	25
PDFG00RD00/1	-	1"	-	25

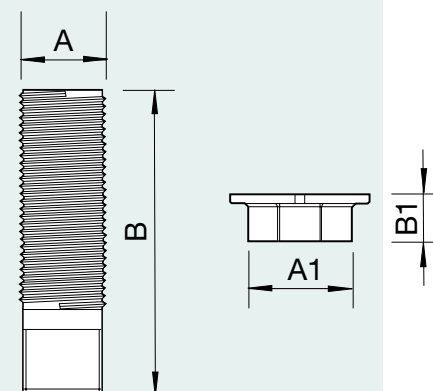

Junction fitting from pipe to tap for beer towers			
P/N	A	B	L
RR08/XX	8	7	25

Flat gasket non included/ xx= customer logo

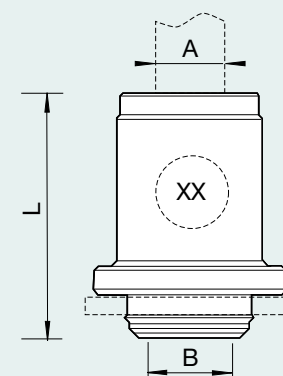

Consult our technical-sales department for all your needs.

Consult our technical-sales department for all your needs.

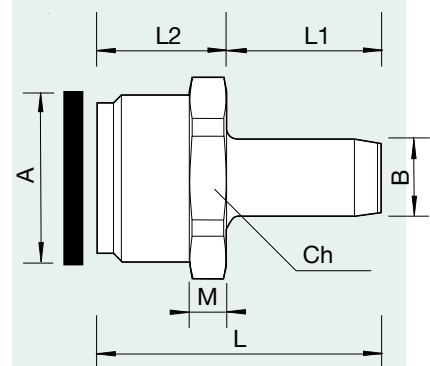

Straight connector male threaded c/w gasket							
P/N	A	B	Ch	L	L1	L2	M
QRC008M3-4/CS	3/4"	8	32	39	21	18	6
QRC10M3/4	3/4"	12	32	39	21	18	6
QRC12M3/8	3/8"	12	32	40	24	16	6
QRC12M1/2	1/2"	12	32	42	24	18	6
QRC12M3/4	3/4"	12	32	42	24	18	6

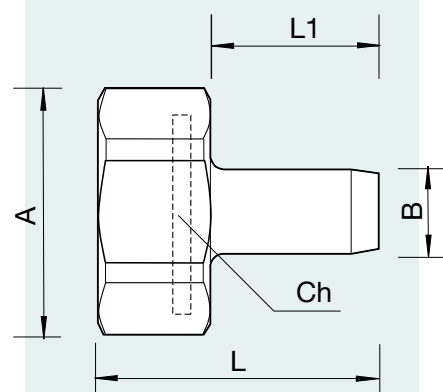

Straight connector female threaded c/w gasket					
P/N	A	B	Ch	L	L1
QRC08F3-4/CS	3/4"	8	32	37	21
QRC10F3/4	3/4"	10	32	37	21
QRC12F3/8	3/8"	12	32	40	24
QRC12F1/2	1/2"	12	32	40	24
QRC12F3/4	3/4"	12	32	40	24

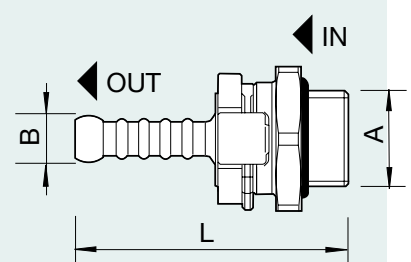

Straight overpressure valve with male threaded c/w o-ring				
P/N	A	Opening pressure	B	L
RVNR05M1/4CL	1/4"	9-11 bar	5	37,5
RVNR05M1/4CL-A	1/4"	1,5 bar	5	37,5

Consult our technical-sales department for all your needs.

Check valve				
P/N	A	Ch	L	øInt. min.
PVNR222200	1/4"	17	45	4

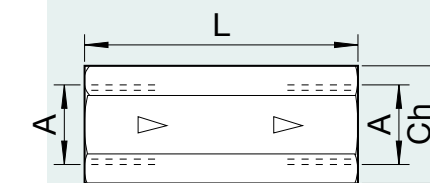

Template for push-in connector for pe-x pipe		
P/N	ø	L
RDIMA06XX12		
A	8	22
B	10	24
C	6	22
D	12	24
E	1/4	22,5
F	3/8	24

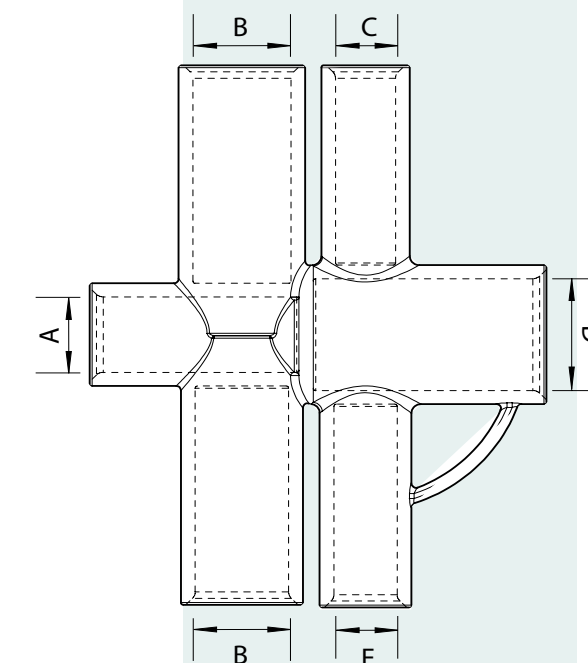

Consult our technical-sales department for all your needs.



PRESBLOCK

www.presblock.com

Pres Block S.p.A.

Via Alpignano, 151 - 155
10040 Caselette (TO) Italia
tel +39 011.9688055
fax +39 011.9688668